

$\phi 8$

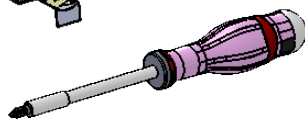
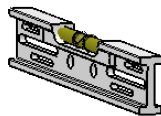

**SENZA 6 GS 494-62-14**

1		
x1		
2		
x1		
3		
x1		
4		
x1		
5	 <b>M8x20</b>	 $\phi 4.8 \times 13$
x2	x2	 $\phi 5 \times 35$
x2		x2
8	 $\phi 20 \times \phi 7$	 $\phi 8 \times 40$
x2	x2	 $\phi 8 \times 40$
x2		x2
11	 $\phi 6 \times 30$	 $\phi 3.5 \times 40$
x6	x6	 s=6
		x1